

INSTRUCTIONS FOR INSTALLING YOUR WESLOCK PRODUCT

Mercy Entry Handle



PARTS INCLUDED

Do not insert key, or unlock handle before installation. Doing so may result in removal of the cylinder assembly.

Wood Screws (x8)

For mounting strikes & faceplates.



Exterior Deadbolt Assembly

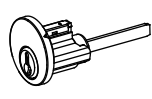

Exterior Grip Assembly

Exterior handle & thumb piece.



Foot Screw Cap Assembly



* Only use one (1-3/4" OR 2-1/4") screw based on thickness of door.

Interior Deadbolt Assembly



Assembly Screws (x3)

Pre-installed on Exterior Grip Assembly for mounting interior knob / lever assembly. 1-1/4"



Lock Cover

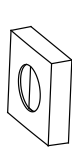

Deadbolt Latch

Engages strike with door closed.

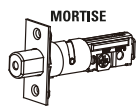

Interior Knob/Lever Assembly

Interior knob / lever, rosette & spindle



Entry Keys (x2)

For unlocking the deadbolt.



Strikes (x4)

Install on door frame.

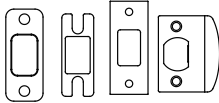

Assembly Screws (x2)

For mounting interior deadbolt assembly.



Thumb Press Latch

Engages strike with door closed.

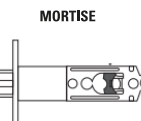

REQUIRED TOOLS

Measuring Tape

Or other measuring tool

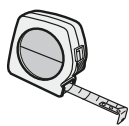

Screwdriver

Phillips and flat blade

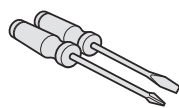

Wood Chisel

*Only if prepping a new door

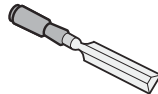

Allen Wrench

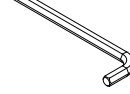

Writing Utensil

*Only if prepping a new door

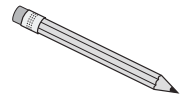

DOOR PREP INSTRUCTIONS 2 WESLOCK.COM

GLOSSARY OF TERMS

Technical language used in this document



MORTISE



CROSS BORE



EDGE BORE



THUMB PRESS LATCH



DEADBOLT LATCH

DETERMINE THE BACKSET OF YOUR DEADBOLT LATCH AND THUMBPRESS LATCH

The length of your latch assembly will be determined by your backset measurement.

MEASURE THE DOOR

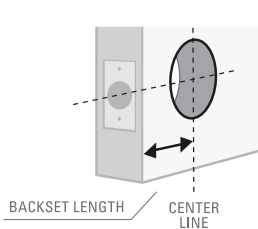

Measure distance between center of crossbore and edge of door.

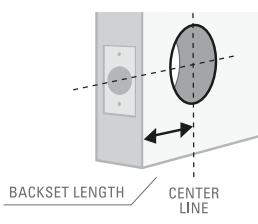

Measure distance between center of crossbore and edge of door.

IF MEASUREMENT = 2 3/8"

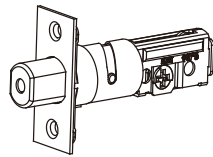

KEEP ADJUSTMENT PIN IN PLACE

Latch leaves the factory with this setting. No adjustment is necessary.

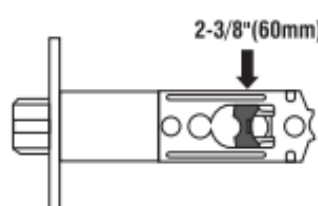

IF MEASUREMENT = 2 3/4"

1 GRASP ADJUSTMENT PIN ON BOTH SIDES

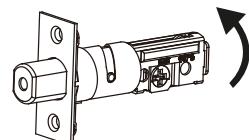

LIFT UP AND SLIDE BACK TO 2-3/4" SLOT

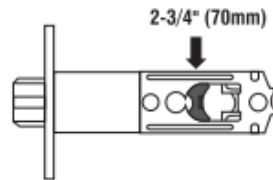

No adjustment is necessary. Leave extension attached to latch assembly.

INSTALLATION

Deadbolt latch must be extended prior to installation.

7A. Insert Non-Mortise Latches

NON-MORTISE

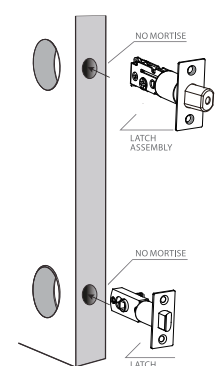

7B. Install Exterior Deadbolt and Grip Assemblies

A. Insert deadbolt tailpiece into cam in deadbolt latch.

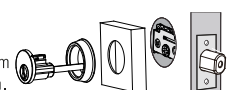

B. Align notches on grip housing with proper grooves (2-3/8 or 2-3/4) on latch. Slide on. At same time, align and insert foot screw through pre-drilled hole.

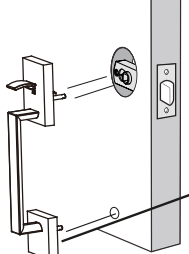

7C. Install Interior Deadbolt and Knob/Lever Assemblies

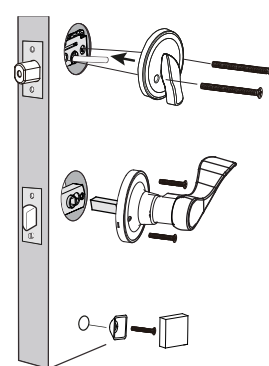

7D. Install Strikes

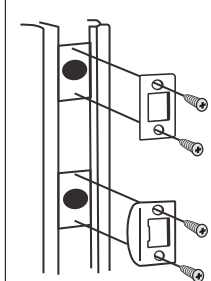

THANKS FOR CHOOSING US. WE HOPE YOU ENJOY YOUR NEW WESLOCK DOOR HANDLE.

WESLOCK WARRANTY INFORMATION

WESLOCK warrants to the purchaser that the products shall be free from defects in material workmanship for the LIFETIME of the product. Provided the product was purchased from an authorized WESLOCK dealer, Weslock's sole obligation under this warranty shall be to repair or replace product which WESLOCK determines to be defective. After such product is returned to WESLOCK by the purchaser with proof of purchase and with shipping charges prepaid, will this warranty be honored. Homeowner - if the product was installed as original equipment on a new home, you must provide the name of the builder, the date the home was built and your move-in date. If a mechanical defect has occurred, it is your right by this warranty to contact Customer Service in Tulsa, Oklahoma at (800) 575-2658 to arrange the return of the lock. This warranty DOES NOT cover products which malfunction due to improper installation or misuse. **Please register your product at Weslock.com.**

WARRANTY TERMS

FINISH

MECHANICAL

Premiere Essentials

Limited 5 year finish

Limited 25 year finish

ADDITIONAL CUSTOMER RESOURCES

Online

WEBSITE

For our full product catalog, and video instructions, go to;

www.weslock.com

TWITTER

To learn about promotions, and other news, follow us at;

twitter.com/Weslock1

YOUTUBE

Browse our video library, or leave us comments at;

youtube.com/WeslockDoorHardware

FACEBOOK

See what we're up to, or ask us a question at;

facebook.com/WeslockDoorHardware

Direct

PHONE NUMBER

1-800-575-2658
BOLT

FAX NUMBER

1-918-294-3869

EMAIL

customerservice@weslock.com
or
warranty@weslock.com

TEMPLATE

